

20007



Oncor Electric Delivery  
Jason Conover  
Associate Designer  
3873 Hwy 69N  
Greenville, TX 75401

March 24, 2026

Office of County Commissioners  
PO Box 1097 Greenville, TX 75403

RE: Pole and Conductor Installation on CR 4615 WO 31514067

Greetings,

Oncor Electric Delivery LLC., is requesting permission to do work within the county right of way along CR 4615, 650' East of the intersection of CR 4615 and TX-34 (176 CR 4615) We are looking to install a new 40/3 Pole approximately 1' inside the Northern ROW of CR 4615. Site location map and permit exhibit are enclosed. The permit exhibit details the proposed work. If you have any questions, please contact at any time.

Sincerely,

Jason Conover  
Designer

FILED FOR RECORD	
at	3:00 o'clock <u>PM</u> M
MAR 24 2026	
BECKY LANDRUM County Clerk, Hunt County, Tex.	
by	

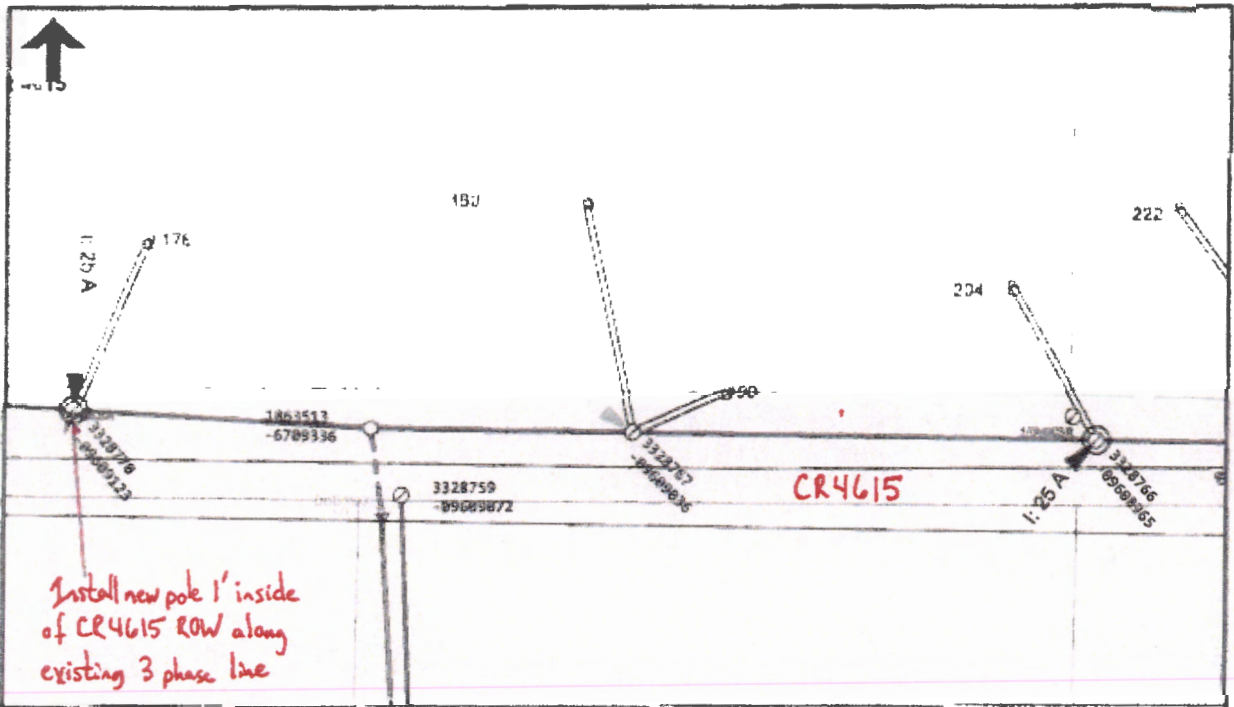

### ELECTRIC CONSTRUCTION PRINT

WO Number: **31514067-01**      Date: 2026/03/11      Description: CEL: CLSTE2101: RESSFR: Bibiana Rodriguez: 176 & 204 Co Rd 4615, Wolfe City 75496: SAC  
 Sheet: **1** of      Scale: 1"=20'      Customer:  
 Job Status: Design      Svc Ctr / Office: CEL/      Address: 176 Co Rd 4615 WOLFE CITY  
 Designer: CONOVER, STEVEN J/LBXX      903-458-0725      Location:  
 Project Mgr: CONOVER, STEVEN J/LBXX      903-458-0725

Copyright 2018 Clever Electric Delivery - Maps, drawings, and electronic data (products) are created for the internal purposes of Clever Electric Delivery with no implication of liability or fitness for the intended use of the mapmaker.  
 Clever Electric Delivery will make good faith efforts to provide products that are free from error, but does not warrant the accuracy or quality of such products. The locations shown are approximations and are not intended to show exact locations.  
 Products provided to other parties by Clever Electric Delivery are for the internal use of the recipient, and the recipient agrees not to duplicate or distribute the products or any portion of the products to third parties without the prior written consent of Clever Electric Delivery. The recipient further agrees to hold harmless and indemnify Clever Electric Delivery against all claims, costs, expenses and damages resulting from or associated with such third parties for personal injuries, death or property damage, an estimate of any claim to the property protected hereunder.